

# TRUCKS TECHNICAL BULLETIN # EN - 23

**DATE:** OCTOBER 12, 1999  
**MODEL YEAR:** 2000 AND AFTER  
**CHASSIS MODEL:** UD1200/1400  
**BULLETIN #:** EN - 23  
**FILE IN THE ENGINE SECTION OF THE TECHNICAL BULLETIN BINDER**

## ENGINE FLYWHEEL AND FLYWHEEL HOUSING CHANGE

### CHANGE NOTICE

The FD46TA engine flywheel and flywheel housing has changed beginning with the 2000 year model UD1200/UD1400 with the Aisin automatic transmission. This change will affect the timing mark location on the engine flywheel, the location of the timing mark opening in the flywheel housing, and the location of the access for disconnecting the automatic transmission torque converter from the engine.

### SERVICE NOTICE

Timing the injection pump to the engine requires the use of the timing marks on the engine flywheel and the timing mark opening on the flywheel housing. The changes made to the flywheel timing marks and the flywheel housing changes the location of these, including the access for the torque converter bolts.



ITEM ↓	LOCATION →	FORMER (1999 MY)	NEW (2000 MY & later)
Flywheel Housing Opening		Bottom	Top Right
Flywheel Timing Marks		Bottom	Top Right
Torque Converter Access		Bottom/Front	Bottom

### INTERCHANGEABILITY

NO, not individually.

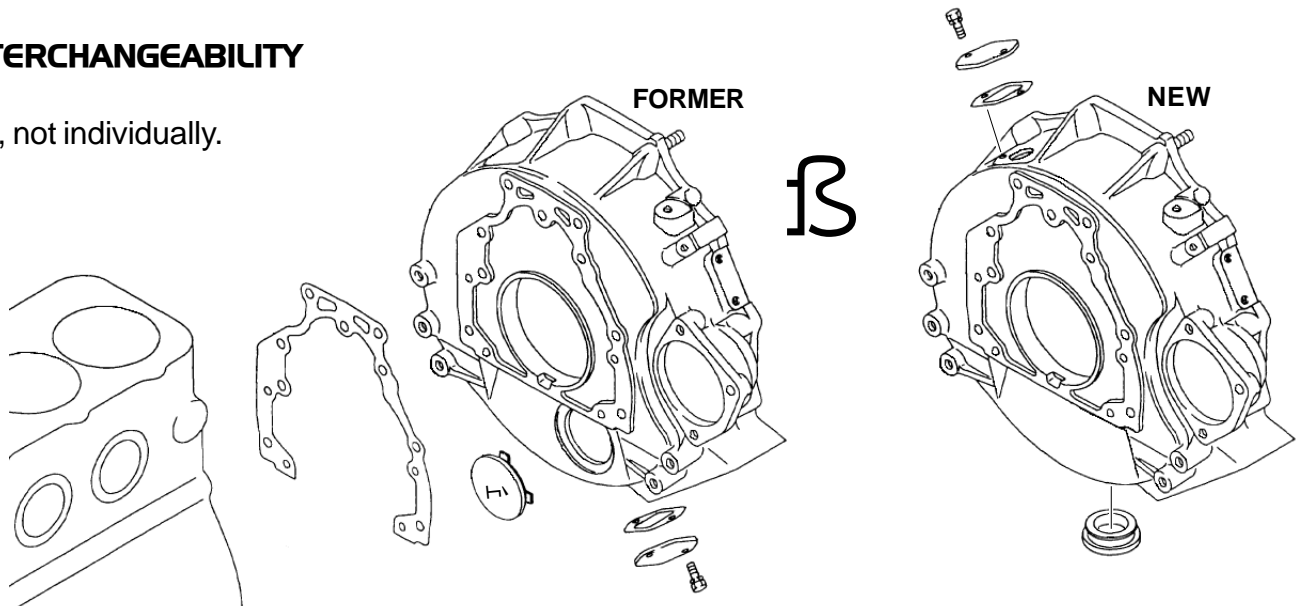

THE INFORMATION CONTAINED IN THIS BULLETIN SHOULD NOT BE INTERPRETED AS THE BASIS FOR CLAIMS UNLESS SO DESIGNATED